

汽车继电器

TRV4-1U

- 40A continuous rating 85°C
- Plug-in or PC board terminals
- Optional mounting bracket
- Conform to ROHS,ELV directive



ORDERING CODE 订购代码

| | | | | | |
|-------------|----------|------------------|----------|----------|------------|
| <u>TRV4</u> | <u>L</u> | <u>—12V (D1)</u> | <u>—</u> | <u>U</u> | <u>— F</u> |
| 1 | 2 | 3 | 4 | 5 | 6 |

- Relay Model 继电器型号
- Coil Power 线圈功率
D=1.9W; L=1.6W
- Coil Nominal Voltage 线圈额定电压
6, 12, 24VDC
- Nil: Standard (标准)
R1: Coil parallel with 1/2W resistor 680Ω for Coil voltage 12VDC
Coil parallel with 1/2W resistor 2700Ω for coil voltage 24VDC
D1/D2: With diode(详见安装图)
- 触点转换形式
U: Form U
- F: WITH BRACKET(有背)
Nil: WITHOUT BRACKET(无背)

COIL DATA 线圈参数 (at 20°C)

| Nominal Voltage 额定电压(VDC) | 6 | 12 | 24 | |
|---------------------------------|--------------------------------|-----|------|------|
| Coil Resistance 线圈阻值(Ω ±10%) | 23 | 90 | 360 | 1.6W |
| Rated Current 额定电流(mA) | 267 | 133 | 67 | |
| Max Operate Voltage 最大吸合电压(VDC) | 3.9 | 7.8 | 15.6 | |
| Min Release Voltage 最小释放电压(VDC) | 0.6 | 1.2 | 2.4 | |
| Coil Resistance 线圈阻值(Ω ±10%) | 19 | 76 | 300 | 1.9W |
| Rated Current 额定电流(mA) | 317 | 158 | 79 | |
| Max Operate Voltage 最大吸合电压(VDC) | 3.9 | 7.8 | 15.6 | |
| Min Release Voltage 最小释放电压(VDC) | 0.6 | 1.2 | 2.4 | |
| Max Applicable Voltage 最大过载电压 | 70°C时额定电压的130%, 23°C时额定电压的170% | | | |

CONTACT DATA 触点参数

| | |
|------------------------------|---|
| Contact Form 触点形式 | 1U |
| Contact Material 触点材料 | Silver Alloy |
| Load 负载 | Resistive load (COS Φ 1) |
| Contact Ratings 触点负载 | NO: 2X20A 14VDC |
| Max Switching Voltage 最大转换电压 | 30VDC |
| Max Switching Current 最大转换电流 | 40A |
| Max Switching Power 最大转换功率 | 560W |
| Contact Resistance 接触电阻 | 100mΩ Max at 6VDC 1A |
| Life Expectancy 寿命 | Electrical 电气寿命: 100,000 Operations(at30 Operations/minute) |
| | Mechanical 机械寿命: 10,000,000 Operations(at300 Operations/minute) |

CHARACTERISTICS DATA 性能参数

| | |
|--|--------------------------------------|
| Insulation Resistance绝缘阻值 | 100M Ω Min at 500VDC |
| Dielectric Strength Between Open Contacts触点间耐压 | 500VAC(for one minute) |
| Between Contacts and coil触点与线圈间耐压 | 750VAC(for one minute) |
| Operate Time吸合时间 | 10ms |
| Release Time释放时间 | 10ms |
| Temperature Range环境温度 | -40 $^{\circ}$ C to +85 $^{\circ}$ C |
| Shock Resistance冲击 | Operating Extremes动作极限: 10G |
| | Damage Limits破坏极限: 20G |
| Vibration Resistance振动 | 10-40Hz, 1.5mm |
| Max. switching frequency最大转换频率 | Mechanical: 18,000operations/hr |
| | Electrical: 1,800operations/hr |
| Humidity湿度 | 40-85% |
| Weight重量 | Approx 40g |

■ ENGINEERING DATA 设计参数

Ambient Temperature

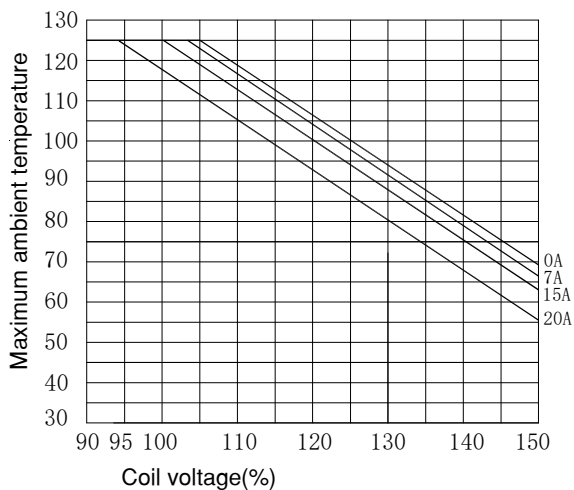

Contact switching capacity

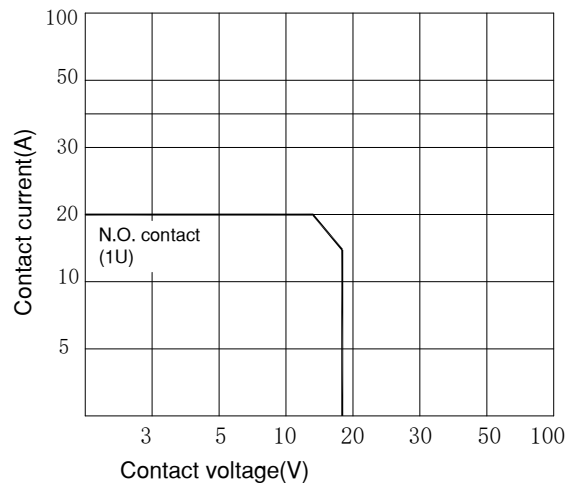

■ OVERALL AND MOUNTING DIMENSIONS 安装图

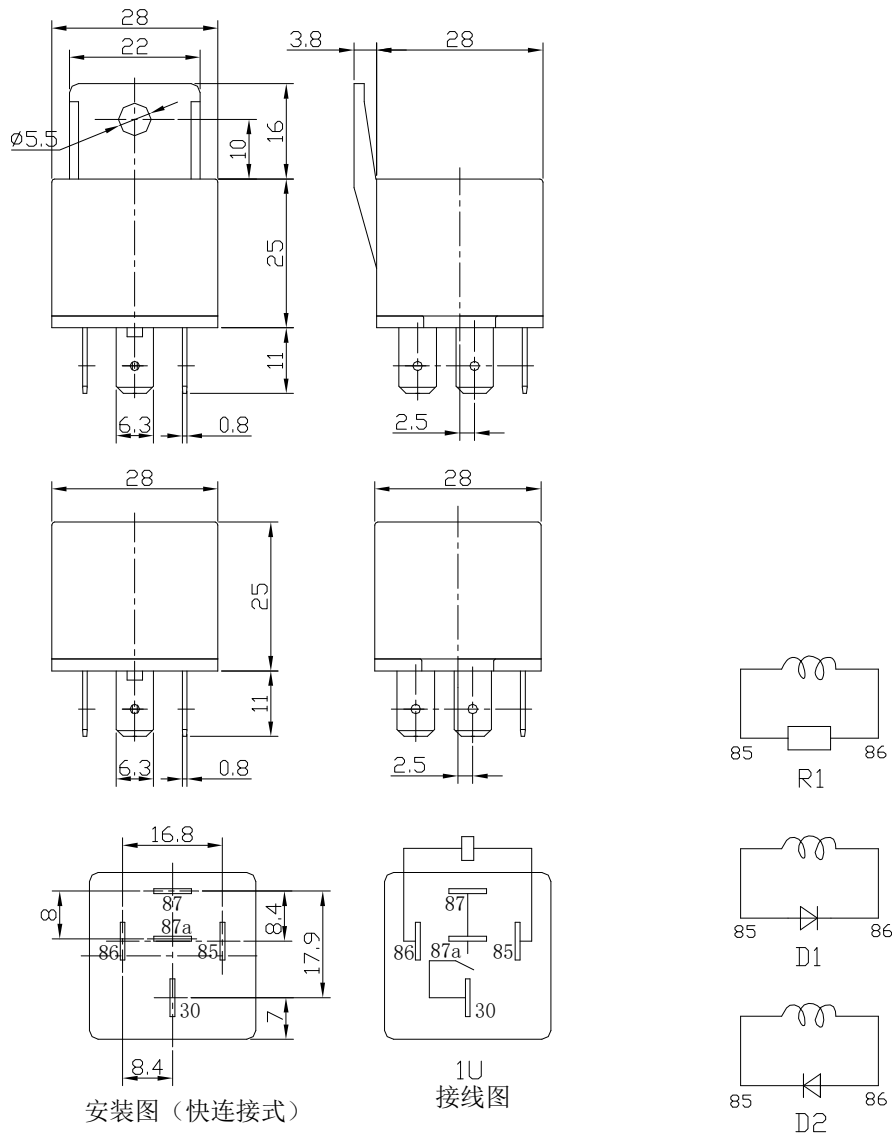

备注: 1) 产品部分外形尺寸中未注尺寸公差: 当外形尺寸 $\leq 1\text{mm}$ 时, 公差为 $\pm 0.2\text{mm}$; 当外形尺寸在 $1\sim 5\text{mm}$ 时, 公差为 $\pm 0.3\text{mm}$; 当外形尺寸 $> 5\text{mm}$ 时, 公差为 $\pm 0.4\text{mm}$ 。

2) 安装孔尺寸中未注尺寸公差均为 $\pm 0.1\text{mm}$ 。

声明:

本产品规格书仅供客户使用时参考, 如有更改, 恕不另行通知。